



LIFAN

Parts Catalog

LF150-10S

2018 Edition



UNIVERSAL

H A R D W A R E®

Box 585, Center Road
Spanish Lookout
Tel 501 823 0254
sales@universalhardware.bz

3380 Chetumal Street
Belize City
Tel 501 224 4140
salesbz@universalhardware.bz



ML100-A



LF110-7A



LF1200DT



ML125-5



ML125-7



ML125T-26



LF150-7



LF150GY-3B



LF200GY-4



LF250GY-4



LF150-10F



LF150-10S



ML200-16D



ML250-4



ML200ZH-3

F-01 前照灯总成 前导流罩 HEADLIGHT & FRONT FAIRING



150101-1	Headlight Assy	
150101-2	Front Windshield	
150101-3	Headlight Hood	
150101-4PUR	Headlight Hood Ornament,RH	
150101-5PUR	Headlight Hood Ornament,LH	



150102-1	Meter Assy	
150102-2	Cable, clutch	
150102-3	Cable comp., throttle	
150102-4	Cable, choke	
150102-5	Seat Lock Cable	



150103-1	Lever comp., clutch	
150103-2	Mirror, rearview, LH	
150103-3	Mirror, rearview, RH	
150103-4	Rubber, Stay, rearview mirror	
150103-5	Weight, steering bar	
150103-6	Grip, LH	
150103-7	Switch, handlebar, LH	
150103-8	Switch, handlebar, RH	
150103-9	Grip comp., throttle	
150103-10	Pipe set, steering bar, LH	
150103-11	Pipe set, steering bar, RH	

F-04 方向柱 STEERING STEM



150104-1	Stem set, steering	
150104-2	Bridge, upper	
150104-3	Lid comp., ignition switch lock	
150104-4	Hood, ignition switch	
150104-5	Top Bearing Top Ball Race	
150104-6	Steering Stem Bearing Set	
150104-7	Top Bearing Bottom Ball Race	
150104-8	Bottom Bearing Bottom Ball Race	
150104-9	Hook	

F-05 前挡泥板 FRONT FENDER

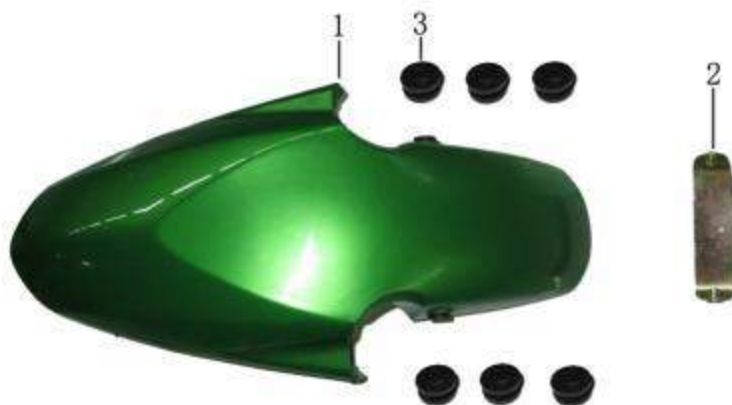

150105-1PUR	Front Fender	
150105-2	Lining set, front fender	
150105-3	Grommet, side cover	

F-06 前液压制动器总成 FRONT HYDRAULIC BRAKE ASSY



150106-1	Front Hydraulic Brake Assy	
150106-2	Disc, front brake	
150106-3	Front Brake Shoe Set	



150107-1	Shock absorber, front, RH	
150107-2	Shock absorber, front, LH	
150107-3	Front License Bracket Comp.	
150107-4	Front License Bracket Press Plate	
150107-5	Stay, speed sensor	
150107-6	Reflector, front	
150107-7	Shock absorber Assy, rear	



150108-1PUR	Tank weldment, fuel	
150108-2	Cushion, fuel tank front	
150108-3	Rubber, front fuel tank	
150108-4	Cushion, rear fuel tank	
150108-5	Sensor, fuel	
150108-6	Hose	
150108-7	Fuel Cock Stay	
150108-8	Vacuum Switch	
150108-9	Fuel Filter Comp.	
150108-10	Hose	
150108-11	Grommet, side cover	

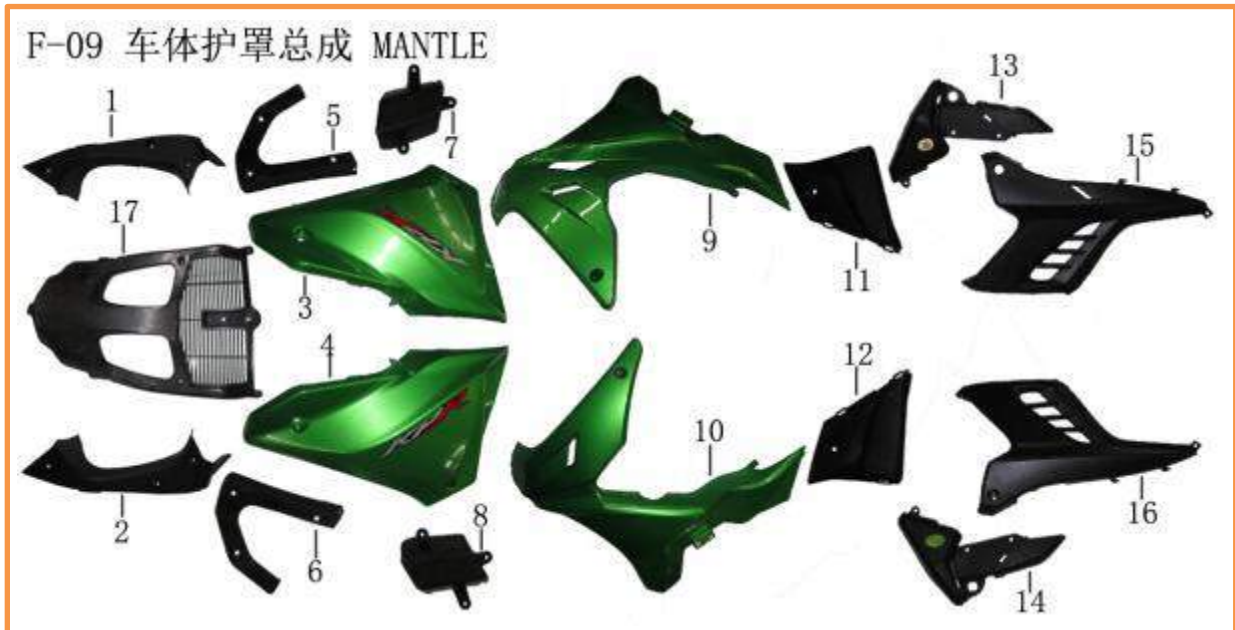

150109-1	Body, meter case upper, RH	
150109-2	Body, meter case upper, LH	
150109-3PUR	Fuel Tank Ornament,RH Comp.	
150109-4PUR	Fuel Tank Ornament,LH Comp.	
150109-5	Ornament set, fuel tank, RH II	
150109-6	Ornament set, fuel tank, LH II	
150109-7	Ornament, fuel tank inner, RH	
150109-8	Ornament, fuel tank inner, LH	
150109-9PUR	Front Fairing Guard,RH	
150109-10PUR	Front Fairing Guard,LH	
150109-11	Ornament, engine, RH	
150109-12	Ornament, engine, LH	
150109-13	Ornament, side cover, RH	
150109-14	Ornament, side cover, LH	
150109-15	Side Cover,RH	
150109-16	Side Cover,LH	
150109-17	Hood, radiator	



1501010-1	Tyre, front	
1501010-2	Hub comp., front wheel	
1501010-3	Sensor, speed	
1501010-4	Axle, front	
1501010-5	Bush, front wheel, RH	



1501011-1	Tyre, rear	
1501011-2	Hub, rear wheel	
1501011-3	Buffer, rear wheel	
1501011-4	Disc, rear brake	
1501011-5	Axle, rear	
1501011-6	Rear Wheel Bush,LH	
1501011-7	Rear Wheel Bush, RH	
1501011-8	Sprocket	
1501011-9	Hub Assy, sprocket	

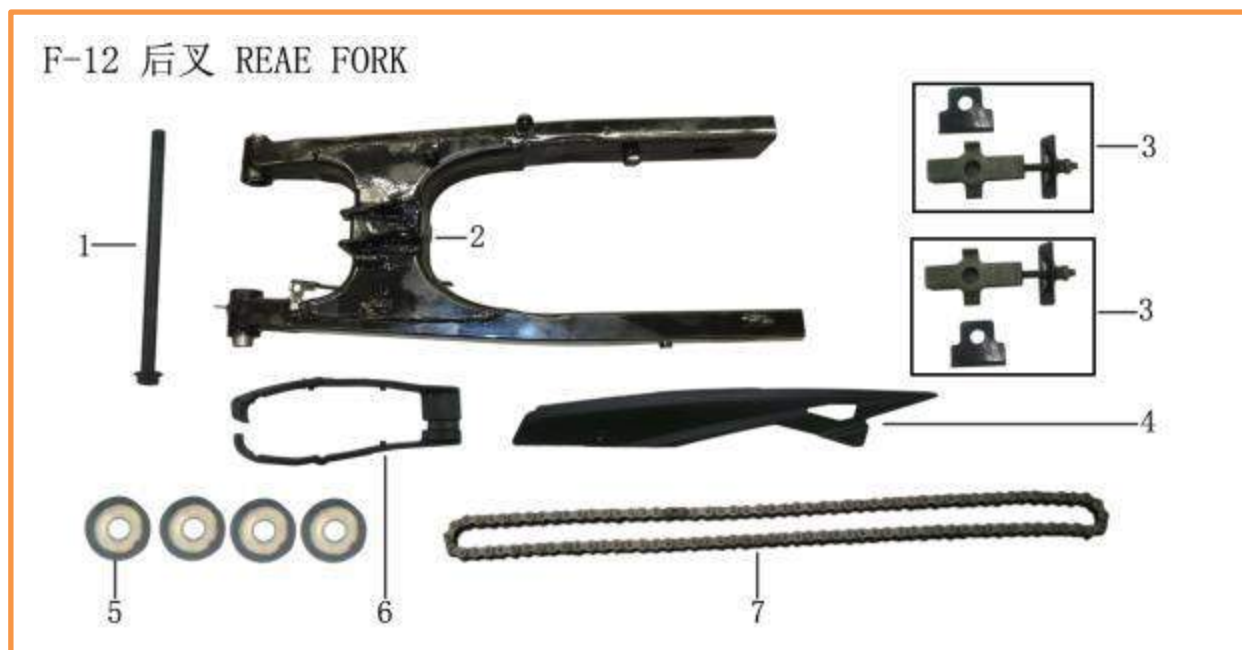

1501012-1	Shaft, rear fork	
1501012-2	Fork comp., rear	
1501012-3	Adjuster set, chain	
1501012-4	Chaincase	
1501012-5	Dust cover, rear fork shaft	
1501012-6	Guide, chain	
1501012-7	Chain, 08MCx128 64	



1501013-1	Seat Assy, rider	
1501013-2	Pad, seat rear	
1501013-3	Cleaner Assy, air	
1501013-4	Element, air cleaner	
1501013-5	Plate, seat rear connecting	
1501013-6	Grommet, side cover	

F-14 排气消声器总成 EXHAUST MUFFLER



1501014-1	Muffler Assy, exhaust	
1501014-2	Gasket set, muffler	
1501014-3	Ornament, muffler	



1501015-1	Flap, rear mud	
1501015-2	Cover, tool box	
1501015-3	Fender, rear	
1501015-4	Ornament, rear	
1501015-5	Light comp., license plate	
1501015-6	Bracket set, front body	
1501015-7	Reflector, rear	
1501015-8	Kit, tool	
1501015-9	Grommet, side cover	

F-16 搁脚组合 FOOTRESTS



1501016-1	Footrest Assy, rider, RH	
1501016-2	Footrest Assy, rider, LH	
1501016-3	Footrest comp., rider, RH	
1501016-4	Treadle, pillion, RH	
1501016-5	Footrest comp., rider, LH	
1501016-6	Treadle, pillion, LH	

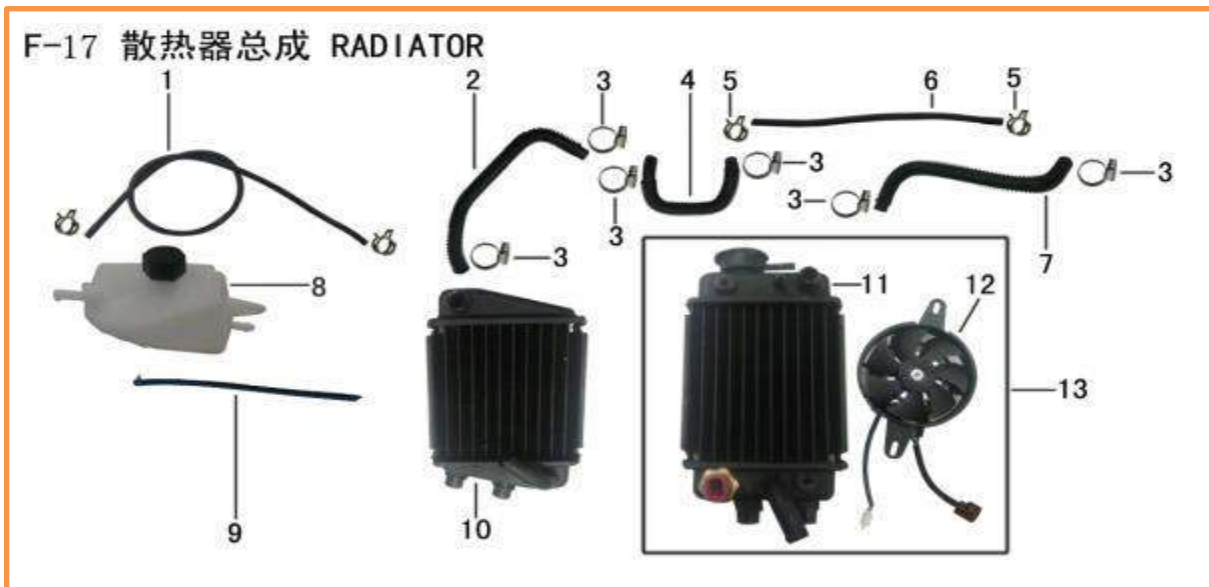

1501017-1	Pipe, storage reservoir outlet	
1501017-2	Hose, radiator inlet	
1501017-3	Clamp, 25	
1501017-4	Pipe., connecting	
1501017-5	Clamp	
1501017-6	Pipe, small	
1501017-7	Hose, radiator outlet	
1501017-8	Reservoir, storage	
1501017-9	Pipe II , storage reservoir outlet	
1501017-10	Radiator set	
1501017-11	Radiator	
1501017-12	Fan Assy	
1501017-13	Radiator set II.	



1501018-1	Cable, main	
1501018-2	Horn	
1501018-3	Relay, flashing	
1501018-4	EFI Relay	
1501018-5	Battery,12N9-BS	
1501018-6	Controller, ignition	
1501018-7	Relay, starting	
1501018-8	Regulator Voltage	
1501018-9	Coil, ignition	



1501019-1	Winker, front, LH	
1501019-2	Winker, front, RH	
1501019-3	Winker, rear, LH	
1501019-4	Winker, rear, RH	
1501019-5	Taillight Assy	



1501020-1PUR	Ornament, rear panel, RH	
1501020-2PUR	Ornament, rear panel, LH	
1501020-3	Plate, rear panel connecting, RH	
1501020-4	Plate, rear panel connecting, LH	
1501020-5	Panel, rear	
1501020-6	Grommet, side cover	



1501021-1	Rear Hydraulic Disc Brake	
1501021-2	Bracket set, rear brake reservoir	
1501021-3	Bracket set, rear brake master cylinder	
1501021-4	Spring set, rear brake pedal	
1501021-5	Pedal, rear brake	
1501021-6	Rear Brake Shoe Set	

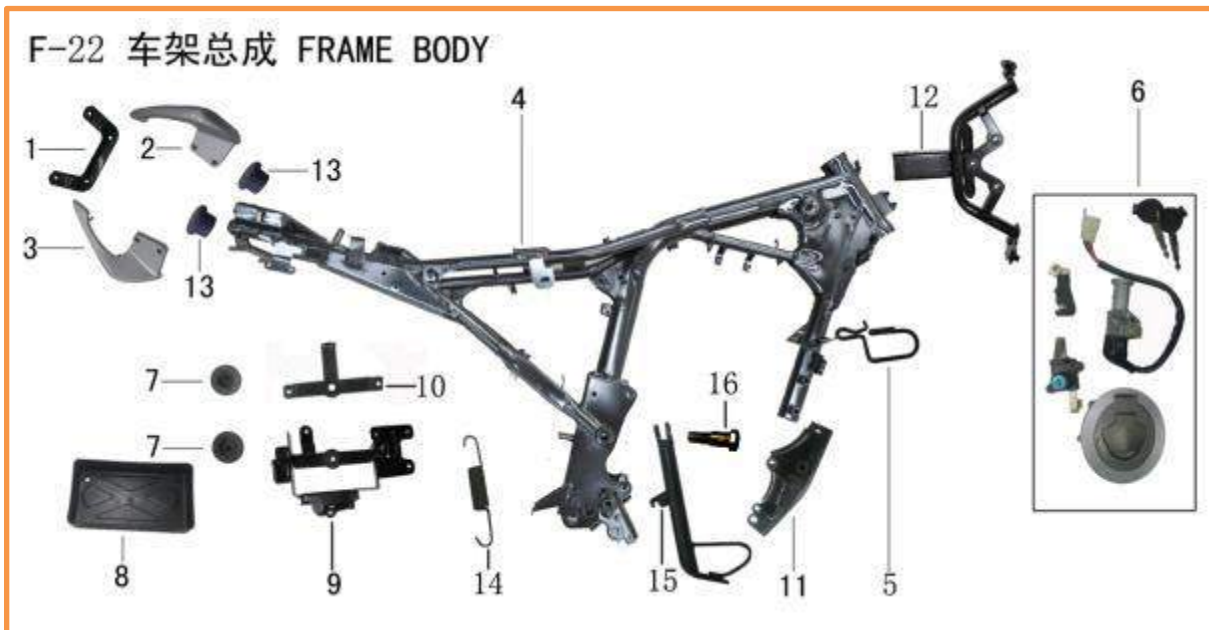

1501022-1	Bracket set, rear panel	
1501022-2	Handrail, LH	
1501022-3	Handrail, RH	
1501022-4	Body weldment, frame	
1501022-5	Clamp, main cable	
1501022-6	Lock Assy	
1501022-7	Cushion, battery	
1501022-8	Case, battery	
1501022-9	Stay set, battery	
1501022-10	Plate set, battery pressing	
1501022-11	Plate, engine front connecting	
1501022-12	Stay comp., headlight	
1501022-13	Frame Hole Plug	
1501022-14	Spring, side stand	
1501022-15	Stand, side	
1501022-16	Bolt, pivot	

F-23 燃油蒸发系统 FUEL EVAPORATING SYSTEM



1501023-1	Fuel Evaporating System	
1501023-2	Stay, Canister, active carbon	



1501024-1	Ignition Controller	
1501024-2	Start Relay	
1501024-3	Voltage Regulator	
1501024-4	Ignition Coil	

158MJ

Engine Parts

LF150-10S



UNIVERSAL

H A R D W A R E®

**Box 585, Center Road
Spanish Lookout
Tel 501 823 0254
sales@universalhardware.bz**

**3380 Chetumal Street
Belize City
Tel 501 224 4140
salesbz@universalhardware.bz**



1581-1	Check Valve Vent Pipe Comp.	
1581-2	Check Valve Vent Pipe Shim	
1581-3	Cap nut M8	
1581-4	Copper washer, bolt, cylinder	
1581-5	Spark plug	
1581-6	Inle pipe set	
1581-7	Thermostat Valve	
1581-8	Thermostat Cover	
1581-9	Block unit, cylinder	
1581-10	Cover, cylinder head, LH	
1581-11	Bolt, M8×45	
1581-12	Gasket, cover, cylinder head, LH	
1581-13	Head unit, cylinder	
1581-14	Retainer, distributing camshaft	
1581-15	Cover, valve	
1581-16	Valve Cover O-Ring	
1581-17	Gasket, cylinder head	
1581-18	Gasket, cylinder block	
1581-19	Dowel pin, cylinder headΦ10×20	
1581-20	Washer, Tensioner	
1581-21	Tensioner Assy	

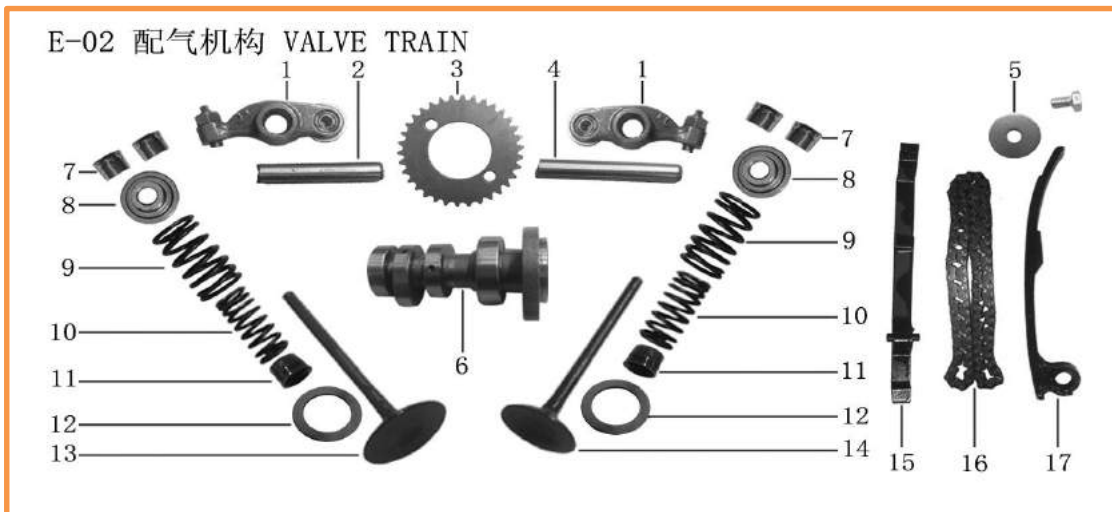

1582-1	Rocker arm Assy,	
1582-2	Shaft, rocker arm II	
1582-3	Sprocket, timing driven	
1582-4	Shaft, rocker arm I	
1582-5	Washer, tensioning plate	
1582-6	Camshaft Assy I	
1582-7	Split cone, valve	
1582-8	Seat, spring, upper	
1582-9	Spring, valve, outer	
1582-10	Spring, valve, inner	
1582-11	Oil seal, valve stem	
1582-12	Valve Outer Spring Seat	
1582-13	Valve, intake	
1582-14	Valve, exhaust	
1582-15	Guiding plate	
1582-16	Chain, timing	
1582-17	Tensioner	



1583-1	Dipstick Assy	
1583-2	O-ring	
1583-3	Cover unit, crankcase, RH	
1583-4	Pump Cover	
1583-5	Dowel PinΦ8×10	
1583-6	Pump Hermetical Circle	
1583-7	Clutch Controlling Rod	
1583-8	Clutch Lever Oil Seal	
1583-9	Clutch Lever Spring	
1583-10	Spring, operating shaft, clutch	
1583-11	Head, cylinder Set Pin (Φ8×14)	
1583-12	Crankcase Cover Gasket,RH	
1583-13	Oil seal, crankshaft, RH	
1583-14	Overflow Pipe	
1583-15	Overflow Pipe Clamp	
1583-16	Bearing 6900	
1583-17	O-ring (Φ34.5×φ1.8)	
1583-18	Pump Assy	
1583-19	Clamp Comp, Water Pipe	
1583-20	Water pipe	
1583-21	Sight Glass	



1584-1	Stud B (M8×196.5)	
1584-2	Stud A (M8×205)	
1584-3	Adjusting support, clutch cable	
1584-4	Crankcase, RH	
1584-5	Dowel pin (Φ10×14)	
1584-6	Gasket, crankcase	
1584-7	Crankcase, LH	
1584-8	Clip, exhaust pipe	
1584-9	Pipe, exhaust	
1584-10	Timing Chain Limited Plate	
1584-11	Pin-Keeping	
1584-12	Pin-Keeping Spring	
1584-13	Pin-Keeping Spring Plate	
1584-14	Oil seal, 20×34×7	
1584-15	Oil seal, gearshift shaft	
1584-16	Gauze filter	
1584-17	Spring	
1584-18	O-ring, cover gauze(Φ35×Φ3)	
1584-19	Cover, gauze filter	



1585-1	Oil Pump Assy	
1585-2	O-Ring (φ9.4×φ2.4)	
1585-3	Shaft, dual-gear I	
1585-4	Washer, Dual-gear	
1585-5	Dual-gear comp. I	
1585-6	Starting motor	
1585-7	Dual-gear comp.II	
1585-8	Shaft, dual-gear II	
1585-9	Gear set, starting clutch	
1585-10	Washer, gear, starting clutch	



1586-1	Stator set, magneto	
1586-2	Flywheel clutch Assy	
1586-3	Rotor set, magneto	
1586-4	Starting clutch Assy	
1586-5	Plug, watch hole	
1586-6	O-ring, watch hole plug	
1586-7	Cover, crankcase, LH	
1586-8	O-ring, $\Phi 63 \times \Phi 3$	
1586-9	Cover, upper	
1586-10	Clip, magneto wire	
1586-11	Stopper, magneto wiring harness	
1586-12	Bolt, M10×45	
1586-13	Thrust washer	
1586-14	Gasket, crankcase cover, LH	
1586-15	Dowel pin, crankcase	
1586-16	Cover, LH	
1586-17	O-ring, plug,	
1586-18	Rear cover, LH	



1587-1	Clutch Mandrel	
1587-2	Clutch Pusher	
1587-3	Bearing, 16003	
1587-4	Lock nut	
1587-5	Thrust washer	
1587-6	Plate, clutch lifter	
1587-7	Spring, Clutch	
1587-8	Disc set, clutch friction	
1587-9	Plate, clutch	
1587-10	Plate, clutch pressure	
1587-11	Center comp., clutch	
1587-12	Clutch Assy	
1587-13	Outer comp., clutch	
1587-14	Body, clutch	
1587-15	Spline washer	
1587-16	Clutch Bush	

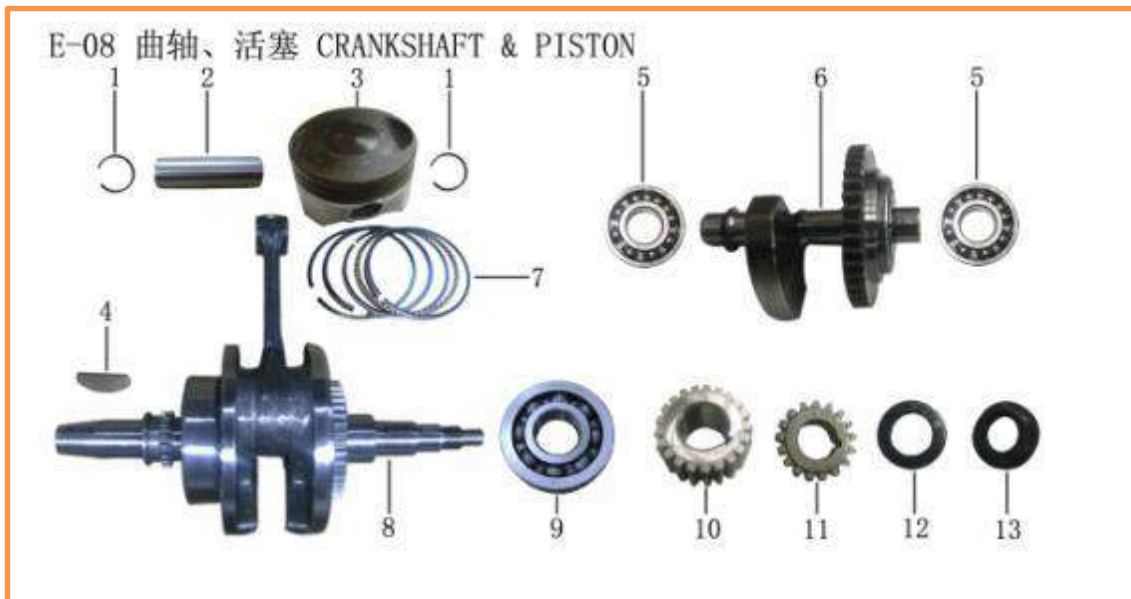

1588-1	Circlip, piston pin	
1588-2	Pin, piston	
1588-3	Piston	
1588-4	Key, woodruff	
1588-5	Bearing, 6202 (15x35x11)	
1588-6	Balanced Shaft Assy	
1588-7	Ring set, piston	
1588-8	Crankshaft & connecting rod	
1588-9	Bearing, crankshaft, RH	
1588-10	Drive gear (sprocket), primary	
1588-11	Drive gear, water pump	
1588-12	Thrust washer	
1588-13	Lock nut	

E-09 传动装置 TRANSMISSION



1589-1	Bearing, 6202 RS	
1589-2	Main shaft Assy	
1589-3	Bearing, 6006	
1589-4	Locating plate, sprocket	
1589-5	Sprocket, output	
1589-6	Bearing, 6204	
1589-7	Countershaft Assy	
1589-8	Bearing, needle, HK152312	



15810-1	Cam	
15810-2	Bearing, needle, HKS212810	
15810-3	Set pin, 4×10	
15810-4	Drum	
15810-5	Shaft, fork	
15810-6	Fork (III)	
15810-7	Fork (II)	
15810-8	Fork (I)	
15810-9	Oil seal,gear indicator contrac point	
15810-10	Gear Indicating Wire Harness	
15810-11	Limit plate	
15810-12	Spring	
15810-13	Gearshift shaft Assy	
15810-14	Point comp., gear indicator contact	
15810-15	Gearshift shaft limiter bolt	

E-11 化油器、变档杆 GEARSHIFT PEDAL & CARBURETOR



15811-1	Carburetor Assy	
15811-2	Inlet Pipe Insulator O-Ring	
15811-3	Inlet Pipe Insulator	
15811-4	Gearshift pedal Assy	

LF 150-10S

Parts Catalog

- **Always wear a helmet while driving Motorcycles**
 - **Always have your headlights on while driving, even during the day – for safety reasons and longer battery life**
 - **Make sure all lights work properly at all times**
 - **Always drive with Insurance Coverage, Licensed Motorcycle and Motorcycle Driver's License**
 - **Change oil (SAE15W/40SE) after the first 500 KMs and after every 2,000 KMs**
 - **Use Regular Gas**
 - ***Always Drive with Awareness for SAFETY.***
- 



Meilun Motorcycle Warranty Policy

Meilun Motorcycles are under 3 months or 2,000 KMs warranty – whichever comes first. Specific items under warranty are:

- The Engine, and its related parts
- Cables, Horn, Switches
- And any other manufacturer's defect on motorcycle.

The following items are *not* covered under this warranty:

- Tires, Tubes, Chain & Sprockets
- Covers, Mirrors, Light Lenses, Alarm System
- Battery – unless convincing evidence shows defect
- And any other damages or wear & tear occurring under the owner's care.